

How to use the Gh XYbh6 cc_b['5 DD Prospective students

1 J]g]h\ hrd.#k k 'i b]gU'UWhU#cc on your phone or PC

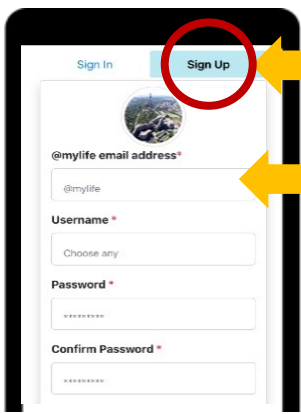

- 1 Click on "G] b' d"
- 2 Register with an 'Ya U]' 'UXXfYgg' and a password of your choice
- 3 Access your 'Ya U]' 'UWti bi' and verify your registration

2 G] b!]b'

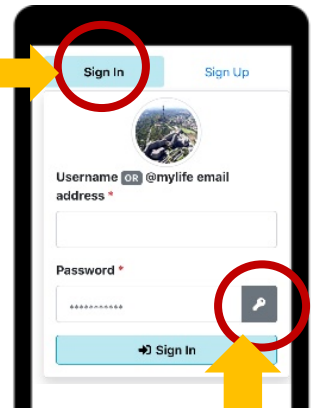

NB =Znci 'Zcf[chnci f'dUggk cfX, use the key button

3 7 ca d`YhY'U6 cc_b[

1 GY'WixU'Y' (limited to today and tomorrow)

2 GdY'WZrifYUgcb'Zcf'Vcc_b[

3 GY'Wihja Y'g`ch (Morning or Afternoon)

4 Select a campus/region

5 Select a building/facility

6 Confirm absence of listed Covid-19 symptoms

7 Submit booking

Cb`mUW'Wgg]V'Y' WUa di gYg# fY[]cbg'UfY'']ghYX

Cb`mUW'Wgg]V'Y' Vi]X]b[g# ZW]]hYg'UfY']ghYX

6 cc_b[]g' VtbZfa YX' cf'fY'W'W'YX

=ZW`bZfa YX'UJ_Y' gWYYbg\ chcZW`bZfa U]cb

NB

Bi a VYf'cZVcc_b[]g'c]g'Uj U]U'W'Y'UfY'fY[i `U'YX 6 Y'W`bg]XYfU'Y'UbX'Xc'bc]c]j YfVcc_ 8 Y'Yh'U'Vcc_b['k\ Yb'bc]h[c]b['

NB

4 AT CAMPUS ENTRANCE GATES

- 1 Follow signs to Screening Points
- 2 Produce screenshot of booking
- 3 Body temperature is scanned and recorded
- 4 Access campus

5 AT BUILDING ENTRANCES

- 1 Produce screenshot of booking
- 2 Security confirms booking
- 3 Access Building or Facility